

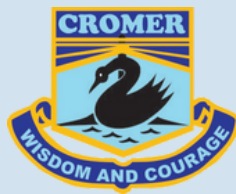

CROMER PUBLIC SCHOOL



INFORMATION
BOOKLET

2025

Respect Responsibility Achievement

CONTENTS

- 04 Key events
- 05 School organisation
- 07 Communication
- 09 Attendance
- 12 Lost property
- 12 Selective high school & opportunity class
- 3 Your child's health and safety
- 15 Learning at our school
- 27 Parent | Teacher communication
- 28 Wellbeing
- 36 Student leadership
- 37 Getting to and from school
- 38 Services provided to families
- 41 Uniform shop
- 43 Parent involvement - P&C
- 44 School song
- 45 School map



WELCOME TO CROMER PUBLIC SCHOOL

At Cromer Public School students, parents and teachers work collaboratively to create a safe and caring learning environment where every child is supported to reach their potential.

Our motto of “Wisdom and Courage” underpins the school’s proud tradition of promoting excellence in all its endeavours. We have the wisdom to value the traditions of the past and the courage to explore new ways of thinking, learning, teaching and leading to achieve school improvement for the benefit of our students.

We are proud of the wonderful school we have developed and the great learning experiences and opportunities we offer our students. Our school is committed to providing a quality education for all students that develops the whole child. Our core values of Respect, Achievement and Responsibility underpin all that we do in a supportive and caring environment.

Our school community has established a culture of excellence, where the highest standards are expected and maintained. The school focuses on quality teaching and learning that caters for all students’ learning needs, with a strong emphasis on literacy and numeracy, and inquiry learning featuring significant and relevant skills for life in the 21st century.



Acknowledgement of Country

We would like to acknowledge the ongoing custodians of the land on which Cromer Public School is located and where we meet, learn and work.

We respect their continuing unique cultural and spiritual relationships to the land, waters and seas and their rich contribution to society.

We would also like to acknowledge the Aboriginal and Torres Strait Islander people throughout our school community.

KEY EVENTS

Term 1

- School Development Days 1-4 (SDD)
- Summer sport Years 3 to 6
- Kindergarten Best Start
- Parent-teacher social interviews
- NAPLAN (Years 3 and 5)
- Swimming Carnival
- Easter Hat Parade K-2
- Life Education

Term 2

- Students return Wednesday 30 April
- Selective high school and opportunity class placement test
- Winter PSSA and winter sport
- School cross country Years 3-6
- Athletics carnival Years 3-6
- Multicultural public speaking competition
- Amazing Me - Stage 3
- Mother's Day stall and breakfast
- School photos
- NAIDOC week
- Semester 1 student reports
- P&C run student discos

Term 3

- Students return Tuesday, 22 July
- Winter PSSA and winter sport
- Years 2-6 Athletics Carnival
- K-2 Athletics Carnival
- Education Week and Book Week
- Stage 3 camp to Bathurst
- Check-in Assessments Years 3-6
- Year 1 phonics assessment

Term 4

- Students return Tuesday 14 October
- Grandparents' day
- Kindergarten transition program
- Summer sport Years 3-6
- Band auditions
- Graduation ceremonies
- Semester 2 student reports

Information about what is happening and exact dates at school is published on: [school's website](#).

SCHOOL ORGANISATION

Staffing

Principal: Julie Johnson

Deputy Principals/Instructional Leaders: Nicole Herrmann, Karen Mitchell

Assistant Principals: Rebecca Thomson, Dan Morton, Melinda Hearne (AP: C&I)

Early Stage One: Rhinane Pervan (KP) Syliva Hardcastle (KH), Rebecca Thomson/Seren Murphy (KT)

Stage One: Katelyn Jackson (1J) Tori Campbell (1C) Louise Jacob/Christine Georgakopoulos (1/2LC) Bridget Outred (2A) Rowena Rien (2R)

Stage Two: Zoe Elliotte (3E), Julia Waugh (3W), Sharon Newling (3/4N), Lauren Peisley (4P) Cathy Scriven (4S)

Stage Three: Kate Behagg (5B), Dan Morton/Ifalemi Paea(5M), Suzie Witts (5/6W), Kassy Gallie (6G), Sharyn Lawler (6L)

Release from face to face (RFF)

Each week, your child's teacher is provided with two hours of release from face to face time for program preparation and administration. Your child will be taught by an additional teacher during that time who will deliver specialist lessons in Science (Kate Murphy), Music (Matthew O'Brien/ Tammi Rolet) , PE (David Frazer) and Library (Laura Edwards/Debbie Haddrick).



Bell times

Teachers are on duty at 8.20am. Parents and carers that need to drop their child at school before this time should book at OOSH.

8:20am - 8.50am Before school
8.50am - 10.50am Morning session
10.50am - 11.10am Recess
11.10am - 12.30pm Middle session
12.30pm - 2.50pm Afternoon session

On Fridays lunch is at 11.50am - 12.50pm and the afternoon session from 12.50pm - 2.50pm to accommodate PSSA sport.

For your child's safety and welfare he/she should not be in the playground or on any playground equipment when it is unsupervised, i.e. before 8:20 am and after 2:50pm. Before School Care (OOSH) is available for students needing care prior to 8:20am, each Monday to Friday.

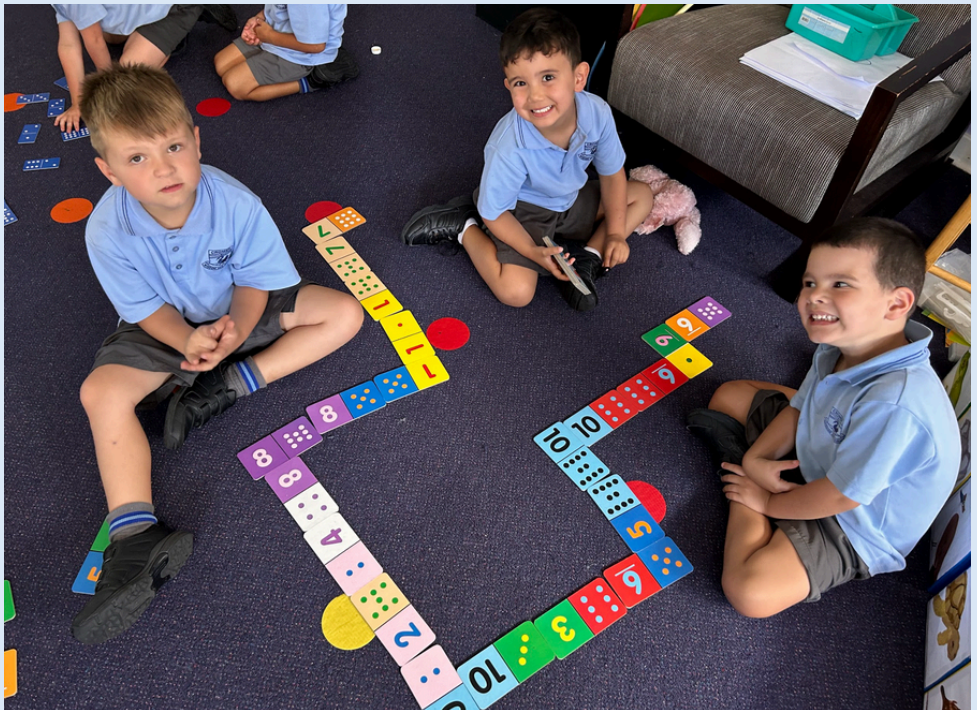

COMMUNICATION

Enrolment

Student eligibility for enrolment is determined under the NSW Department of Education zoning regulations. Where eligible, a student can be enrolled in Kindergarten at the beginning of the school year if they turn five on or before 31 July of that year. All children must be enrolled by their sixth birthday. Visit our website for the [enrolment process](#).

STEP 1: [Apply online](#). To apply online, you must:

- be an Australian or New Zealand citizen or permanent resident live in the local enrolment area of this school.

If you are not eligible to use the online form you can download the [Application to Enrol in a NSW Government school form](#)

STEP 2:

Collect the following documents which are required to support your child's enrolment at our school:

- Proof of student's residential address (lease or council rate notice, electricity or gas notice)
- Birth certificate and proof of citizenship by way of passport.
- Australian Immunisation Register (AIR) Immunisation History Statement.

STEP 3:

Please book an enrolment appointment by calling the school office on 9971 0499. Please bring all completed documents to this appointment.

Best Start Interviews for Kindergarten

When your child starts school, the Kindergarten teacher will observe what your child already knows about literacy and numeracy. This is the Best Start Kindergarten Assessment which assists teachers to support individual student learning needs and is used for all Kindergarten students in NSW public schools. Best Start interviews are held in class time during the first five weeks of school.

Communication with the school

Central Parent Portal

Parent Portal: for academic reports, absences and online permission notes for students. The school will help you to set up this account.

School Bytes

The school's preferred method of payment is online through the school bytes parent portal. [For instructions on how to download the school bytes parent portal.](#)

Website

General information about the school including school calendar.

Social Media

Success stories are shared on [Facebook](#) & Instagram.

Newsletter

Information about what is happening at the school along with school community activities and initiatives are published in the school newsletter which is emailed and uploaded to the website every fortnight.

Interviews

Interviews can be requested with staff if required by emailing or calling the school.

Email

Newsletter, Statement of Account, excursions, incursions and general messages. Email: cromer-p.school@det.nsw.edu.au

Class parent

The class parent representative is a volunteer who manages a class contact/email list for the purpose of communicating between school and parents from the roll class. The distribution list is not used for social purposes or to promote business or fundraising information.

CONTACT INFORMATION

Cromer Public School

Carcoola Road CROMER 2099 Phone: 9971 0499

Email: cromer-p.school@det.nsw.edu.au Website: <https://cromer-p.schools.nsw.gov.au/>



ATTENDANCE

Regular attendance has countless benefits for your child's learning and development. Parents play an important role in ensuring students get to school and stay in school every day.

Reasons for missing school

Being absent, late or leaving early

- If your child misses school for any reason, please contact the school within 7 days to explain why.
- If your child needs to arrive late or leave early, please notify the school.
- If you have difficulty getting your child to school on time every day, please also contact the school. School staff are here to support you and your child to help them come to school.

Travel

Families are encouraged to travel during school holidays. If travel during school term is necessary, discuss this with your child's school principal. An [Application for Extended Leave](#) will need to be completed for six or more days of leave. Absences relating to travel will be marked as leave on the roll and therefore contribute to your child's total absences for the year.

Emergency contact details

Emergency contact details are to be provided at time of enrolment. In the event of an accident the school will use this information to inform either parents/carers or their emergency contacts. Please inform the office via email of any changes to your contact details.

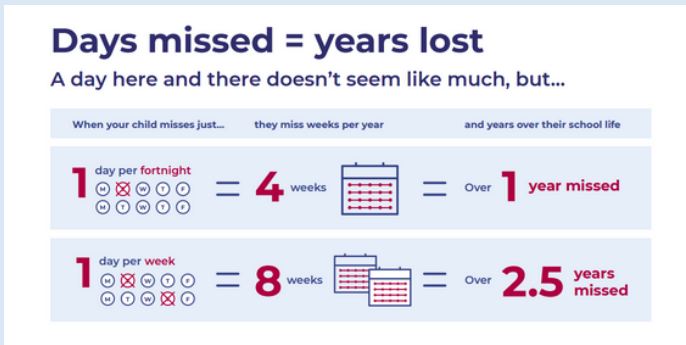



Lost property

All clothing and property should be clearly labelled with your child's full name and class. Lost property is located in the breeze way next to the school canteen.

Lost property items are kept until the end of each term. Unclaimed items remaining at the end of term, that are not labelled are laundered and placed in the second hand section of the uniform shop. Non-uniform items are placed in a recycled clothing bin.

High school placements

Local high school placement is affected by a local catchment system and Expression of Interest forms are distributed to all students in Year 6 in February/March.

Selective High and Opportunity Class placements

Applications for selective high school or opportunity class placements are online. For more information: <https://education.nsw.gov.au/public-schools/selective-high-schools-and-opportunity-classes>

YOUR CHILD'S HEALTH AND SAFETY

First aid

Schools assist students with health support in a range of ways, including providing first aid (including emergency care), temporary care when students become unwell at school, administering medications and health support procedures, and commencing individual health support planning if required. Parents and carers or a nominated contact person, will be notified if medical attention is necessary. Please ensure the school always has a current telephone number for emergency calls.

Immunisation

NSW Health recommends that all children entering school be fully immunised and have booster shots against Diphtheria, Tetanus, Pertussis (Whooping Cough), Polio, Measles, Mumps and Rubella prior to school enrolment.

At enrolment the school will request an immunisation history statement to be provided. In cases where this cannot be provided, the child will be enrolled but will be excluded from school during those periods where there are a number of students infected with the above diseases.

Infection, disease and exclusion periods

The NSW Department of Education requires that students with infectious diseases are excluded from school.

For more information please refer to the NSW Government website on infectious diseases at: health.nsw.gov.au/Infectious/factsheets/Pages/childhood.aspx

DISEASE	PERIOD OF EXCLUSION FROM SCHOOL
Chicken Pox	7 days after the first spots appear or when scabs have fallen off.
Conjunctivitis	Exclude until discharge from the eyes has ceased.
COVID-19	Not to attend with mild cold/flu like symptoms.
German Measles	7 days after appearance of rash.
Head Lice	Parents/carers of students affected will be contacted by the school. When a case is detected the school will also notify all students in the affected class. No exclusion from school.
Ringworm	Exclude until all evidence has disappeared.
Viral Hepatitis	Exclude until medical certificate of recovery has been received.
Whooping Cough	Infectious children are restricted from going to school until the first 5 days of special antibiotic has been taken.

Medical history

If there are any changes to your child's medical history and/or treatment, please advise the school office in writing. If your child has a high risk medical condition, an Individual Health Care Plan will need to be completed.

Medication

Medication to be administered during school hours should be given to the office with a [Permission to administer medication](#) form. The prescribed medication must be contained in a pharmacy labelled container detailing the student's name and the prescribed dosage. Please contact the office for requirements on specific medications.

Medication not prescribed by a doctor will NOT be administered at school. The school will not receive any medication without a signed form. Students are not permitted to keep medication with them or to self-medicate.

Food allergies

While the school strives to reduce the likelihood of nuts being brought to school, the school cannot guarantee it is free of allergy producing products.

We urge students, parents and carers not to send high risk foods to school. All parents and carers are required to provide accurate, current medical information to the school, including medical plans for the management of severe food allergies.

Staff are informed as to the medical conditions of students with anaphylaxis and other food allergies, and are trained in anaphylaxis awareness, including the use of auto-injectors eg. Epi-Pens.



YOUR CHILD'S HEALTH AND SAFETY

Health care plans

An individual Health Care Plan is required for any student with particular physical or medical needs including: · severe asthma · type 1 diabetes, epilepsy and anaphylaxis or · any student who is diagnosed as being at risk of an emergency or · any student who requires the administration of specific health care procedures

Individual Health Care forms are available on the website. These plans should be prepared in consultation with a General Practitioner.

Once completed, the Individual Health Care Plan must be returned to the school office. Parents of students with anaphylaxis should make an appointment with the school to develop a Health Care Plan prior to enrolment. The school updates plans annually in consultation with parents.

Sunsmart

Our students are required to wear a school hat (either the school's broad brimmed hat or peak hat) outside at all times. The school has a 'no hat, play in the shade' policy. We recommend that students apply sunscreen before coming to school and have their own individual roll of sunscreen in their lunchbox which can be reapplied at lunch, particularly in the summer months.

Supervision of students

Teachers supervise students from 8:20 am at school.

There is no playing on the fixed equipment before 8.50 am and after 2.50pm. Staff remain with students until students leave, or are collected from the school grounds at the end of the day. If a student is not collected by 3:00 pm they are taken to the school office.

Where there has been some urgent or unforeseen circumstance, arrangements for collection of the student will be made by the school with one of the nominated contact adults.

Playground equipment

Playground equipment is for the students' of the school's use only during school hours under teacher supervision. Please do not allow your children to play on the equipment without a teacher present (before and after).



LEARNING AT OUR SCHOOL

Curriculum

Information regarding the K to 6 syllabuses can be found on the National Education Standards Authority's (NESA) website at:

educationstandards.nsw.edu.au/wps/portal/nesa/home

The six key learning areas (KLAs) in primary school are:

- English
- Mathematics
- Human Society and its Environment (History and Geography)
- Science and Technology
- Personal Development, Health and Physical Education
- Creative Arts

Additional curriculum programs

- **Library** The Library is the resource centre of the school and is open during some lunchtimes throughout the week for students to visit. It aims to develop a passion for reading through literature lessons and assists in the development of information skills throughout the school.



- **Music & Drama** Students from Years K to 6 attend weekly music lessons with the music teacher, as part of the school's Creative Arts program.
- **Science** Students from Years K to 6 attend weekly science lessons with a science teacher.
- **PE** Students from Years K to 6 attend weekly physical education lessons with a PE teacher.
- **Technology** Students have access to a wide range of technology in both the classroom, K-2 computer lab and the library. Students have access to Microsoft and Google products. Each classroom has a bank of iPads and laptops for Years 3-6 classes to support student learning.
- **Aboriginal Education** Teachers work in partnership with our local Aboriginal community in planning, programming and delivery of teaching and learning programs. Ongoing community consultation underpins successful implementation and student learning outcomes in Aboriginal Studies.
- **EAL/D Education** (English as an additional language or dialect) aims to develop EAL/D students' English language competence across the curriculum, so that they can fully participate in schooling.
- **Garden and Environmental Education** There is a strong emphasis on sustainability and environmental education. The school is diligent in recycling paper, plastics and e-waste. There is a lunch time gardening club which looks after the vegetable garden. Produce is sold to community and to the canteen.

The students are encouraged to bring as little waste as possible to school. Waste free lunches are encouraged and should only be packed in compostable or recyclable containers. In supporting this initiative please refrain from using plastic wrap, foil, zip lock bags and sending packaged foods as much as possible.

Our school vegetable and edible indigenous gardens allows all students an opportunity to participate in 'real world' learning experiences.



LEARNING AT OUR SCHOOL

Learning and support

The school runs specialised programs for students requiring additional support with their classwork. Programs include individual, group and whole class support with a specialist learning and support teacher. Programs are personalised to support students' literacy, numeracy and social skills development. The learning support programs are monitored by the school's Learning and Wellbeing team.

School Counsellor

The School Counsellor is available in the school on Mondays, Tuesdays and Wednesdays to assist students, teachers and parents with any problems that may arise in relation to their child's education/ well-being. Parents may ask for the counsellor's assistance or students may be referred to the counsellor by the Principal, Deputy Principal, or the class teacher. This process needs to go through our Learning and Wellbeing Team. Parents are encouraged to discuss their concerns with the class teacher or the Principal so that, if necessary, a referral can be made to our Counsellor.

High potential and gifted education

The school caters for the needs of high potential and gifted students in a variety of ways, by offering:

Challenging teaching and learning programs; Differentiated lessons; Enrichment programs - participation in arts festivals, dance groups and music, drama and debating English, Math Olympiad mathematics, writing, spelling and science competitions. District and state competitions including sport, creative arts, poetry and debating

For more information visit:

education.nsw.gov.au/teaching-and-learning/high-potential-and-gifted-education



LEARNING AT OUR SCHOOL

Support Class

Cromer PS has one support class, catering for students with additional needs. These students are valued members of the Cromer School community and the development of understanding and acceptance by all -- children, parents, and teachers -- is strongly promoted.

These students are integrated into all school activities whenever appropriate. Their involvement makes a positive contribution to the school climate.

Health and Medical Needs

Students in the support classes often have specific needs. Parents are asked to complete and return the following forms if required.

The following forms are required on enrolment and updated annually:

- Health Care Plans - Medical information, Emergency/Ambulance
- Administering Medication
- Travel Arrangements

Reporting to Parents

Each student in the support class has an Individual Education Program.

Goals are set at the Parent/Teacher interviews in Term 1. A meeting involving parents, teacher, School Counsellor, a member of the District's Student Services and therapists if requested, is held during Term 2 or Term 3. At this meeting student progress and future goals are discussed. A written report of this meeting is forwarded to parents.

Sport

The students in the support class are integrated into each grade's mainstream sport program and participate in a Lifesaving Program at Collaroy Beach. Students also take part in inter-school Carnivals for swimming and athletics.

Transport

If transport is required to and from Cromer Public School, please contact the class teacher or the Deputy Principal who will be able to advise you of the application process and procedures.

Excursions | Incursions

Excursions/Incursions provide enrichment to class learning programs. They are organised by teachers and always have the approval of the principal. The assistance of helpers during class excursions is greatly appreciated. As required, teachers will request volunteers to assist with excursion organisation.

Prior to each excursion or incursion, a permission note explaining the nature of each excursion/incursion and cost is emailed to parents and carers.

A local excursion permission note signed at the beginning of each year allows classes to walk locally to enhance classroom learning.

Homework

The school encourages the completion of as many homework tasks families can manage. In the beginning stages of schooling most activities will be based on home reading and simple activities related to gathering information for class discussions. Activities are age dependent and become more structured as students move through the different stages of their education.

Home reading program

Home readers are provided to students in Years K-2. The home reading program allows students to practise reading skills learnt in class. It is designed to improve students' fluency and expression through exposure to texts which the students can read independently. Parents and carers are encouraged to support the home reading program by listening to their child read on a regular basis.

Special religious education (SRE) and special education in ethics (SEE) classes

Trained volunteers visit the school each week on Wednesdays and parents and carers are asked to indicate which class they would like their child to attend when they enrol. Currently, classes are offered in:

Combined Christian SRE (also known as protestant SRE) is provided by C3 Church Sydney in conjunction with SRE teachers from Anglican and Baptist churches.

Catholic SRE (Scripture) lessons are provided by the Catholic Diocese of Broken Bay.

Special Education in Ethics SEE lessons are provided by Primary Ethics.

A non-scripture group is also available for students whose parents and carers prefer they be exempt.

LEARNING AT OUR SCHOOL

Sport

Sport is an integral part of the school's Personal Development, Health and Physical Education (PDHPE) curriculum and students of all ability levels are catered for through the school's K-2 and 3-6 sport programs.

The school is a member of the Primary School Sports Association (PSSA). This association consists of 12 local Public Schools and organises zone carnivals and competitions including the Friday afternoon competitive sports program for students in Years 3-6, known as PSSA. Students who are not involved in PSSA competitions participate in the school sport program. This program emphasises games skills training and encourages a positive attitude towards sport.

School carnivals are held during the year for students who are 8 years or older for Swimming, Cross Country and Athletics. Winners from school carnivals proceed to Manly Zone carnivals then to Sydney North Regional carnivals and finally to State and National championships. Students in K-2 have an Athletics carnival in Term 3. Parents are invited to attend these events.

Sports Houses

Upon enrolment, students are grouped into four sport 'houses'. Siblings are placed in the same house.

The new logos for the Cromer Public School sports houses were re-designed in 2023 in consultation with local Aboriginal Elders. Each animal is selected in Dharug language, the wider Sydney language and the coastal dialect has been used where possible.

Each logo is circular in shape with an outer ring, inner ring and whole centre. The circles symbolise equality and represent the strong value of a natural balance within Aboriginal culture. This balance is applicable to all parts of social life and community, Country, the land and life around us. Traditionally, Aboriginal people learnt about Country through observation of all around them and discussion with Elders to hear more about their experiences. When co-existing and thriving alongside various wildlife, we learn how other species hunt, gather, shelter and thrive. This artwork has a circle of tree roots that connect the inner ring to the centre of each work, representing a deep grounding and interconnectedness to Country that is grounded on mutual respect and a sense of curiosity for the diversity across our lands. Between the inner and outer rings of each logo, there are unique symbols selected to represent an important aspect of each featured animal.

The four houses are:

Bugari
pronounced
'booh-gah-ree'



Wulaba
pronounced
'wool-ah-bah'

Guma
pronounced
'gooh-mah'



Gulamany
pronounced
'gooh-lah-mah-nee'







LEARNING AT OUR SCHOOL

Extra curricular activities

Band The school's band program comprises of three bands which are open to students in Years 3 to 6:

- Training band (Year 3)
- Intermediate band (Year 4)
- Senior band (Years 5-6)

Strings All students in Year 2 learn to play the violin as part of their weekly music lessons. The school has a string's program.

Each of the bands and string groups have a director/conductor, a paid professional who oversees the musical development of the band or string program.

At the end of each year, instrument trials are held for students in Year 2 to join the band or strings program.

Students who wish to participate in band/strings must be prepared to devote out of class time to tutorial lessons for their instrument as well as band/strings rehearsals. The bands rehearse twice a week, either before or after school or during lunchtime. The strings group rehearse once a week, either before or after school.

The bands and strings perform at school events and a number of community based concerts. Students in the band and strings participate in a music camp.



Choir

The school has two choirs:

- Junior choir
- Senior choir

The junior choir is not audition based and students who enjoy the experience of choral singing are encouraged to join. The senior choir is based on an audition.

Students who are a member of a choir are required to attend weekly rehearsals and perform throughout the year at a number of school functions including assemblies and Education Week performances. Students who are members of senior choir may also have the opportunity to participate in choral festivals and School Spectacular.

Dance groups

The school has junior and senior dance groups and a number of hip hop groups.

Annual auditions are conducted for places in both ensemble programs. Throughout the year the ensembles perform at school events and the Sydney North Dance Festival. Students may also have the opportunity to participate in School Spectacular.

Drama

The school provides opportunities for interested students in Years 3 to 6 to laugh, create, improvise and perform. Performance opportunities vary each year and students are required to audition for parts.

There are two drama groups:

- Junior drama
- Senior drama

Public speaking

Students in Years 3 to 6 are given the opportunity to participate in school and interschool public speaking programs and represent the school in the Multicultural Perspectives Public Speaking competition.





PARENT | TEACHER COMMUNICATION

Student reports

Student reports are provided at the end of Term 2 (Semester 1) and Term 4 (Semester 2). These reports assess a student's performance over the semester in specified outcomes in each Key Learning Area.

Parent-teacher meetings

Parent-Teacher meetings are held in Term One and Term Two.

We welcome discussions with parents and request that you make an appointment to meet with your child's teacher when required at a mutually suitable time. This allows teachers to fulfil their commitments in the classroom and provides an uninterrupted scheduled time for your discussion. Parents and carers may request an interview at any time by emailing or calling the office.

Term Overviews

Term overviews are emailed at the beginning of each term. The overview details the topics and concepts the students will be studying that term. The overview is a guide and the topics and concepts may vary.



WELLBEING

Student wellbeing

Cromer Public School's School Behaviour and Management Plan reflects the Department's commitment to creating quality learning opportunities for students to build on their individual strengths and enabling them to connect, succeed and thrive in their lives.

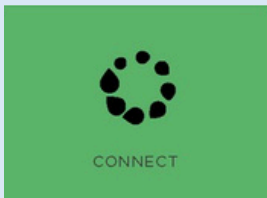

The school is committed to providing a safe, secure and happy environment which encourages each student to:

- be actively connected to their learning, have positive and respectful relationships and experience a sense of belonging to their school and community be respected, valued, encouraged, supported and empowered to succeed grow and flourish, thrive and prosper.

Positive Behaviour for Learning (PBL)

Underpinning the school's student wellbeing framework is the Positive Behaviour for Learning program. The program supports a positive environment in which learning and student engagement is enhanced through consistent expectations. It incorporates a continuum of practices that include:

- school-wide values of respect, responsibility and achievement
- formal instruction in social skills helping students to regulate their own behaviour
- pro-active supervision in all areas of the school regularly rewarding positive student behaviours

RESPECT
RESPONSIBILITY **ACHIEVEMENT**

RESPECT



be kind and inclusive

RESPONSIBILITY



be safe and helpful

ACHIEVEMENT



be engaged and prepared to learn

Awards

Positive Behaviour Engaged Learners

Cromer Values



Be safe & helpful



Be engaged & prepared to learn



Be kind & inclusive

Free and Frequent

To instantly reinforce positive behaviour.
Lucky dip draws each week.

Examples:

Listening, being on task, neat work, Showing Respect, Responsibility, and Achievement.

Principal Stickers



Weekly

5 per week / One for 10 nights reading/
assembly- best class

Merit Awards



Two per week (K-2)

Three per week (3-6)

One per week (K610)

Each child receives at least two a year.

Examples:

Improved presentation

Listening or contributing in class discussions

Effort in.....

Twelve Principal stickers- One Merit award

Principal's Award



One per week

Each child receives at least one a year.

Examples:

Excellent results in.....

A diligent student

Excellent narrative about.....



AWARDS STRUCTURE



12 Principal/Deputy Principal Stickers

1 PBL Value Award



1 Certificate of Excellence

A total of 6 awards of any combination of PBL Values plus a Principal Award



3 Certificates of Excellences

1 Banner



3 Banners

1 Cromer Medallion

Behaviour code for students

Information for students and parents or carers

NSW public schools are committed to providing safe, supportive, and responsive learning environments for everyone across a range of settings. We teach and model the inclusive and safe behaviours we value in our students. In NSW public schools students are expected, to the best of their ability, to:

- show respect to other students, their teachers and school staff and community members
- follow school and class rules and follow the directions of their teachers
- strive for the highest standards in learning act in a courteous and respectful way that makes all members of the school community feel valued, included and supported
- resolve conflict respectfully, calmly and fairly
- meet the school's agreed uniform policy or dress code
- attend school every day (unless legally excused)
- respect all property
- be safe and not be violent or bring weapons, illegal drugs, alcohol, vapes, e-cigarettes or tobacco into our schools
- not bully, harass, intimidate, or discriminate against anyone in our schools.

Schools take action in response to behaviour that is detrimental to self or others or to the achievement of high-quality teaching and learning.

All students have a right to:

- safety at school
- access and fully participate in their learning
- be treated with respect by other students, teachers and school staff
- express their views, set goals and self-advocate.

The principal and school staff, using their professional judgment, are best placed to maintain discipline and provide safe, supportive and responsive learning environments and apply an appropriate action when students are not meeting these expectations. The department is responsible for the provision of a policy framework and resources such as legal issues bulletins, access to specialist advice, and professional learning to guide principals and their staff in exercising their professional judgment. In this context, the NSW

Government and the Department of Education will back the authority and judgment of principals and school staff at the local level.

Behaviour code for students: Student actions
Promoting the inclusion, learning, wellbeing, and safety of all students in NSW public schools is a high priority for the Department of Education.

We implement teaching and learning approaches across a range of settings to support the development of skills needed by students to meet our high standards for respectful, safe and engaged behaviour.

To meet the expectations set out above, students in NSW public schools, to the best of their ability, should adhere to the following principles.

Respect

- Treat one another with dignity.
- Communicate and behave courteously.
- Act and work cooperatively with other students, teachers, and school staff.
- Develop positive and respectful relationships.
- Value the interests, ability and culture of others.
- Respect the learning needs of other students.
- Dress appropriately by wearing the agreed school uniform or dress code.

Take care with school property and the property of staff and other students.

Safety

- Model and follow school and class rules and expectations around behaviour and conduct.
- Negotiate and resolve conflict.
- Be aware of and take responsibility for how their behaviour and actions impact others.
- Care for self and others.
- Be safe and help others to make safe choices that do not hurt themselves or others.

Engagement

- Arrive at school and class on time.
- Be prepared for every lesson.
- Actively participate in learning.
- Aspire and strive to achieve the highest standards of learning.

WELLBEING



Anti-bullying plan

Students attend school to participate in quality education that will help them to become self-directed, lifelong learners who can create a positive future for themselves and the wider community.

Any inappropriate behaviour that hinders teaching and learning at the school and interferes with the wellbeing of students is not accepted. Students, teachers, parents, carers and members of the wider school community have a shared responsibility to create a safe and happy environment, free from all forms of bullying.

The school is proactive in its approach to building a happy, safe, friendly climate where all students work towards the common goal of learning and tolerance in a safe environment. This is reflected in the School Behaviour Support and Management Plan and the teachers' active and on-going commitment thorough supervision, professional development, classroom management and teaching.

For more information on anti-bullying strategies for NSW public schools refer to:

<https://education.nsw.gov.au/schooling/schooling-initiatives/anti-bullying/parents-and-carers>



Cyber safety

The internet provides an opportunity to enhance students' learning experiences by providing access to information. Online communication also links students to a collaborative learning environment.

The school also teaches students the information and communication skills necessary to use the internet effectively and appropriately including how to be cyber safe using the Digital Citizenship toolkit digitalcitizenship.nsw.edu.au to empower them to understand how their online behaviour affects themselves and others.

WELLBEING

Assemblies

Whole school and departmental (K-2 and 3-6) assemblies acknowledge students who demonstrate the school's Positive Behaviour for Learning values. Assemblies are held on Fridays.

Information about school assemblies is published in the school newsletter. Parents and carers are welcome to attend each of our K-2 and 3-6 Awards assemblies. Parents are emailed out an invitation to attend the assembly if their child/ren are receiving an award.

Buddies

A class 'buddy' system to support younger students and develop leadership skills in older students. Buddy classes meet regularly to do a variety of activities:

- play games together
- write and read stories together
- art and craft activities
- combined technology lessons
- gardening together

Birthdays

Some students like to celebrate their birthdays at school. 'Birthday ice blocks' can be purchased from the school canteen to share with classmates.

Fruit and vegetable break

Each morning classes take a short break to 'refuel' on vegetables or fruit and 'rehydrate' with water. Evidence tells us that children who are not hungry and are well-hydrated perform better in the classroom, show increased concentration and are less likely to be irritable. Individual class teachers decide when it best suits their class schedule to stop for this important break. Please ensure your child has a small container of healthy fruits and/or vegetables each day.

Mobile phones

In line with Department of Education Policy, mobile phones and 'smart devices' (including smart watches) are not to be used at school.

The phone must be turned off at the school gate and put away immediately. The phone must be off all day and only be turned on when leaving the school grounds or when the parent/carer has assumed responsibility of their own child. The school will not take responsibility for any loss or damage of the phone while at school.

STUDENT LEADERSHIP

School leaders

The student leadership team has two vice captains and two school captains and ministers. The leadership team is highly active in organising and supporting school events, running assemblies and representing the school at official engagements. The school leaders meet with the principal and deputy principal each week to discuss the impact their roles are having on the student body.

The school's student leadership program is aimed at providing extensive opportunities for all Year 6 students to develop skills of cooperation and teamwork to enhance personal confidence, promote high self-esteem and develop a sense of pride in the school.



GETTING TO AND FROM SCHOOL

Entrances and Exits

Students enter and exit the school through gates. These gates are locked during school hours. Parents can enter the school via the gate closest to the school office on Carcoola Ave during school hours. Parents are required to sign in at the office as a visitor on arrival if they are assisting in classrooms.

Kiss and Drop

The school is located in a 30 km school zone where a 30 km speed limit applies for the hours of 8:30–9:30am and 2:30–4:00 pm on school days. There are 'No Stopping' signs either side of the children's pedestrian crossing and bus zones.

There are limited car parking spaces available around the school. Kiss and Drop Zones are located outside the school in Carcoola Road where parents/carers are allowed to stop for no more than 2 minutes to drop their children off and drive away. Please note drivers must stay with their vehicle at all times.

Travelling by bus

Bus routes State transit buses accommodate school students. For further information, please contact State Transit INFOLINE 131500 or visit their website: transportnsw.info/school-students

Bus timetable For information on bus timetables, please visit: <https://transportnsw.info/stop?q=G209521#/> Please check timetables as buses and timetables are subject to change

Bus passes - opal card For information on eligibility and guidelines, please visit: transportnsw.info/tickets-opal/ticket-eligibility-concessions/child-student-concessions/primary-secondary-school

Bus conduct

Students are expected to abide by the [rules of Transport for NSW Code of Conduct](#) relating to travel on buses and follow the directions of the bus driver when getting on the bus, travelling on the bus or getting off the bus.

Bicycles | scooters

Parents and carers are responsible for students who ride their bicycles to school. Students who travel to school by bicycle or scooter must wear the approved safety equipment. Electrical bikes are not permitted on the school grounds. It is also expected that students travelling by bicycle will wear full school uniform except for the school hat.

For the safety of all students, bicycles or scooters are not to be ridden in the school playground at any time. During school hours these are to be stored in the bike shed located under the school hall.

The NSW Department of Education recommends that students under 10 years of age do not ride bicycles to or from school unless accompanied by an adult. For further information please refer to education.nsw.gov.au/road-safety-education



Change of normal pickup procedure

Emergencies

Please call the office on 9971 0499 if an emergency changes the normal pickup procedures for your child. If the emergency occurs in the afternoon before pickup time, students will be encouraged to wait for collection in the office.

Early pickup by another adult If your child is being collected early by someone other than yourself, please email or call the school office on the morning of the early departure, giving your permission, the name of the person collecting your child and the approximate time of collection.

If a situation arises during the day which necessitates a change of arrangements, please contact the office to inform them of the changes.

SERVICES PROVIDED TO FAMILIES

OOSH - Cromer Kids Club

OOSH Northern Beaches, is a privately owned local business, providing before and after care and vacation care at Cromer Public School. Experienced and trained supervisors staff the centre.

Cromer Kids' Club has its own air-conditioned room within the western side of the school grounds including the oval, play equipment and basketball court for activities. The staff collect the younger students from the Kindergarten set as a the end of the school day and escort them safely to the centre.

OOSH operation hours

7.00 - 9.00am

2.45 - 6.00pm

How to enrol

For information regarding enrolments, visit [OOSH website](#) or call the centre during operating hours.



Canteen

The Canteen is staffed by managers who are employed by the P&C to operate the canteen with the assistance of volunteer parents. The canteen is open five days a week at recess and lunchtime. Volunteers willing to assist are eagerly sought. If you are interested in helping out in the canteen please contact the school for further information.

Kindergarten children are not allowed to use the canteen during the first half of Term One for the purchasing of items at lunchtime. They are introduced to the use of Trolley Tuesday throughout Term One.



Photographs

Class, individual and special group photographs are taken by a photographer once a year. Payment directly to the photographer online or through an envelope system is required for all photographs.

Parents and carers give media consent at the time of enrolment as part of the enrolment application form.

Photographs and videos are also taken by the staff at a range of school activities. Parents and carers may amend their consent at any time.

Uniform shop

The school encourages students to wear the appropriate school uniform. The uniform is non-seasonal, so students should dress according to the weather conditions, rather than the time of year.



The uniform shop is run by the P&C Association, with our manager and volunteers working hard to enable us to supply quality uniforms. All profits from the uniform shop go back into the school and support the education of our children.

Ordering

All uniforms are available for purchase from the uniform shop or [online](#).

Online orders are packed and delivered to the students during term time only, generally on Tuesdays and Thursdays. You will receive an email notification when your order has been delivered to your child's teacher.

Opening hours

- Tuesday 8:30am to 10:30am
- Thursday 1pm to 3pm

Online orders will be processed on Tuesdays and Thursdays.

Collections



Bags

6 products



Boys' Uniform

23 products



Girls' Uniform

43 products



Hats & Miscellaneous

17 products



Kindy Starter Collection

28 products



Music Essentials

4 products



Socks & Tights

11 products



Sport

12 products



Summer Uniform

7 products



Winter Uniform

15 products

PARENT & CITIZEN ASSOCIATION

The Parents and Citizens Association (P&C) is a forum for parents and the extended school community to communicate with the school.

The P&C is run by parent volunteers who donate their time and expertise. The objectives are to:

- promote close cooperation between parents, citizens, students and teaching staff
- encourage parent participation in supporting the school
- assist in raising funds to provide facilities and equipment for the school
- support the recreation and welfare of students at the school

The P&C is responsible for operating our school canteen, uniform shop and music program for band and strings. It also plays an important role in fundraising for specific facilities, equipment and resources for the school. A key part of this fundraising is to provide opportunities for the school community to come together so that parents and children can socialise.

The P&C is responsible for the governance of the following sub-committees:

- Fundraising
- Canteen
- Music
- Uniform Shop

P&C meetings

The P&C Association usually meets in Week 4 and Week 8 each term. You can confirm meeting times on the calendar on the school's website. We welcome you to come along to any P&C meeting. If you would like to put an item on the agenda for a meeting, please contact the P&C at cromerpublicschool@pandcaffiliate.org.au.

Becoming involved

The P&C encourages parent involvement and participation in our school community. Helping out is a great way to be involved in your child's school life, support the teaching staff, get to know other families and contribute to your community.



Volunteering

There are many ways you can contribute by helping out when we need volunteers to support events and fundraising activities or volunteering on a committee. The canteen and uniform shop and all of the subcommittees are always looking for volunteers. You can view many of the volunteer opportunities on the P&C's group [sign-up](#) page. This page is updated throughout the year.

If you're interested in being involved in one of the P&C's sub-committees, you're welcome to attend any meeting or you may like to forward an enquiry to cromerpublicschool@pandcaffiliate.org.au.

Becoming a member

Membership of the P&C Association is open to all parents of currently enrolled students and citizens living within the school community. You may join as a member at any time, however, membership does not become 'active' until the close of the next general meeting of the association. A membership form may be downloaded from "documents" on the P&C [teamapp](#) website.

Finding out more about P&C

You can find all the latest P&C news on the Cromer P&C teamapp. This is where you will sign up to your class list to receive communications from your Class Parent as well as to receive news and information on upcoming meetings, events and fundraising from the P&C. You may download the free Team App from the Apple or Google Play app store. Alternatively, you can use the website version at [Cromer Public P&C](#).



SCHOOL SONG

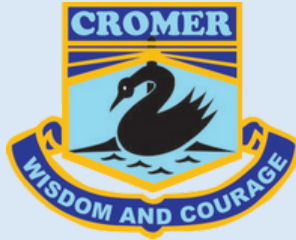

Oh Cromer School we pledge,
Our loyalty.
For wisdom and courage,
We proudly come to thee.

We aim to win but feel no disgrace
If we cannot match the play
Each thought and deed takes its proper place
As we follow in the Cromer way.

We'll strive for truth
And happiness
And remember as the years go by.
Oh Cromer this our school, we love so well.



SCHOOL MAP

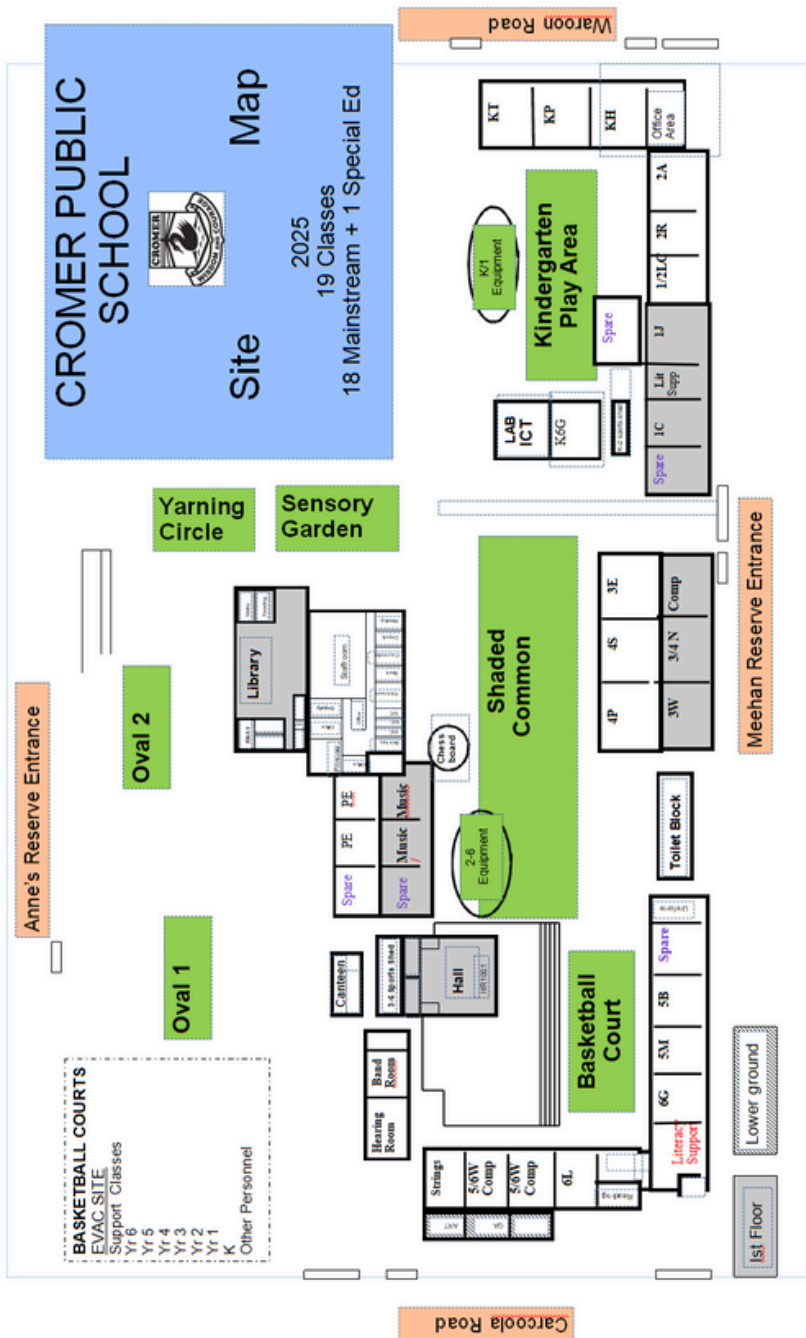

**Cromer Public School
Wisdom and Courage**

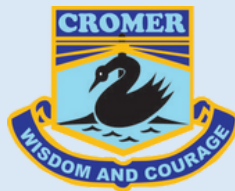

T: Telephone 02 9971 0499

E: Email cromer-p.school@det.nsw.edu.au